

PARKING SECTION

 ATECO CORPORATION اتیکو کورپوریشن					
					

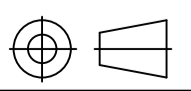
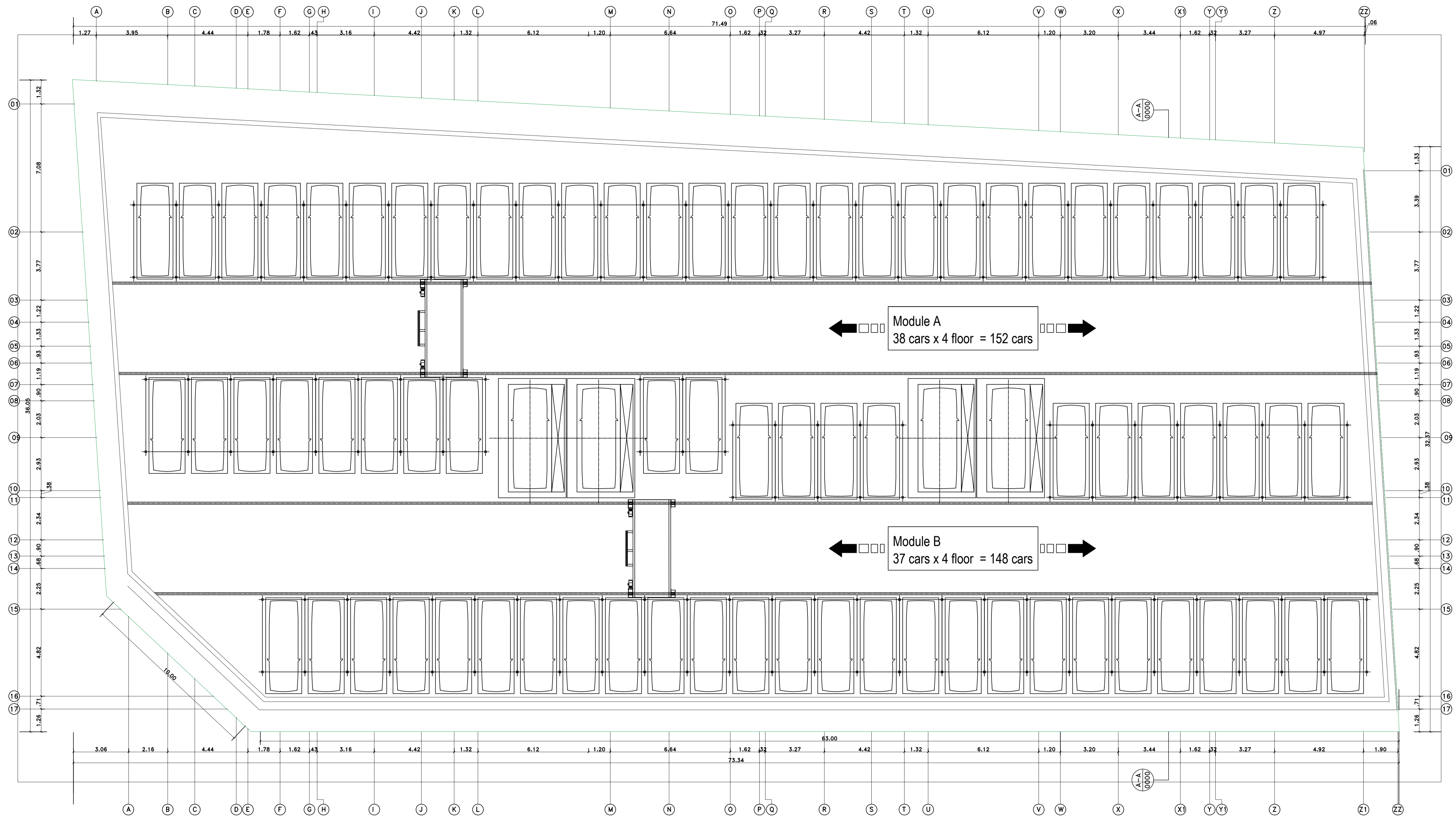

BASEMENT FLOOR -2

PARKING PLAN (TYPICAL FLOOR)

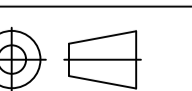

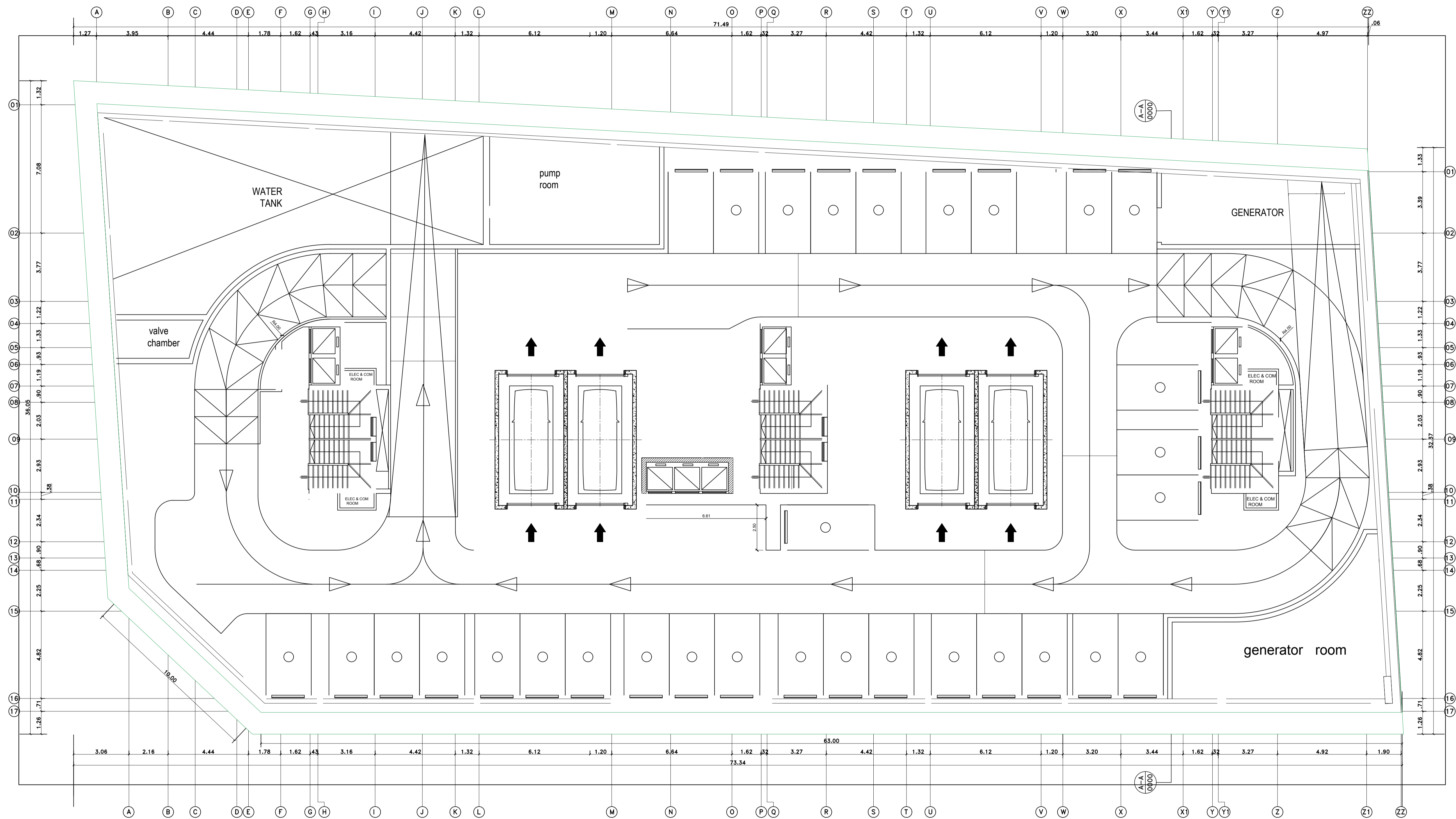

BASEMENT FLOOR -1

ENTRANCE PLAN (B1)

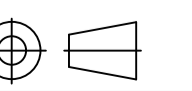

Specification

Capacity		Total 300cars (SUV 300cars)	
Model		Module A : GP-F-LT2C4-152L Module B : GP-F-LT2C4-148L	
L I F T	Hoisting	Motor	22KW x 4P Geared Motor
		Speed	45 m/min Max
	Sliding	Motor	1.5KW x 4P Geared Motor
		Speed	38 m/min Max
		Mechanism	Driving at the Friction Wheel
C A R T	Travelling	Motor	1.5KW x 4P Geared Motor, 2Set
		Speed	72 m/min Max
		Mechanism	Direct Driving at the Cart Wheel
	Picking	Motor	1.5KW x 4P Geared Motor
		Speed	38 m/min Max
		Mechanism	Driving at the Friction Wheel
	Shifting	Motor	0.4KW x 4P Geared Motor
		Speed	7.5 m/min Max
		Mechanism	Direct Driving at the Pinion & Rack
Auto Door	Opening	2500mm(W) x 2100mm(H)	
	Opening Type	SLIDING Panel Open	
	Motor	0.2Kw x 4P	
	Opening Speed	20 m/min	
Control	Speed Control	Inverter	
	Sequence Control	P.L.C Control	
	Operation Board	Touch Screen	
Power		AC 380/400/420V, 50/60Hz, 3P	

All materials should be supplied based on KS or DONG YANG Standard

Available Dimension of Cars

Total Length	5150mm
Total Width	2150mm
Total Height	1900mm
Total Weight	2200kg

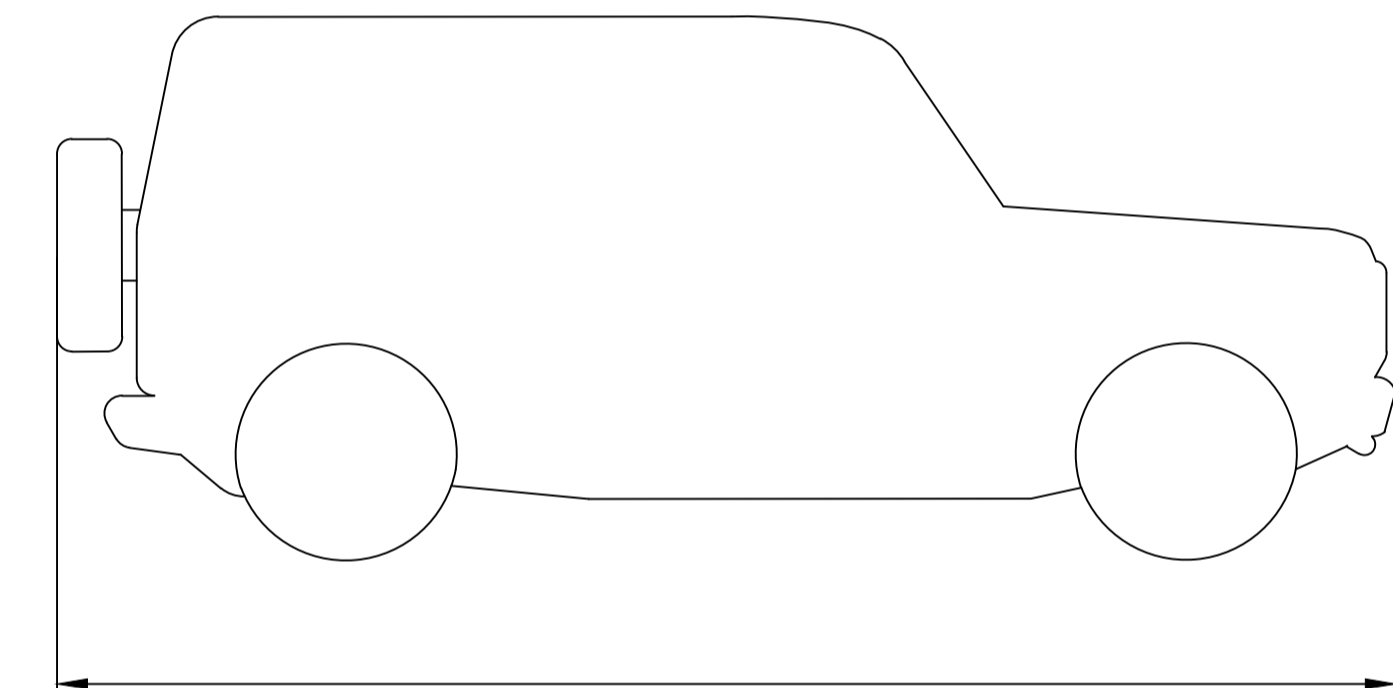
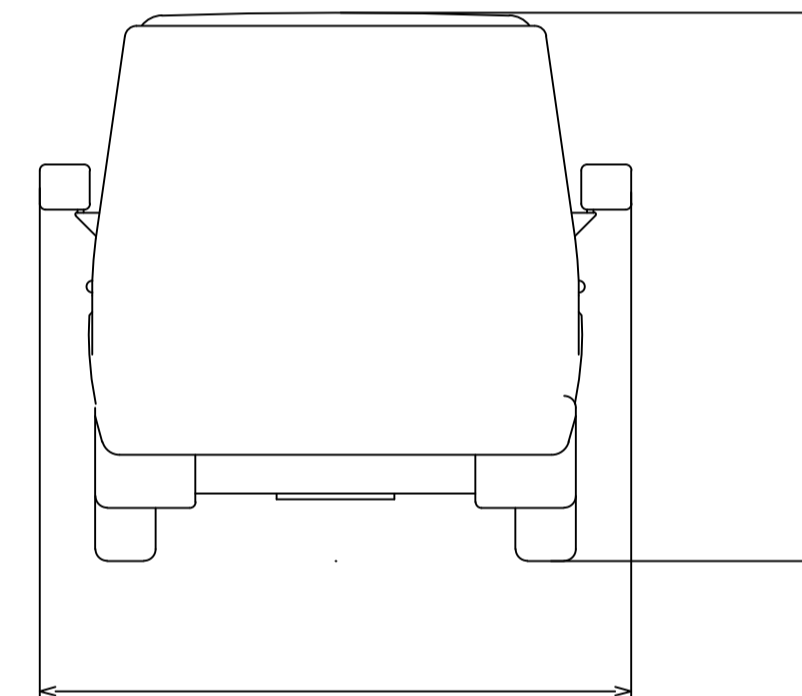

SUV

EGY-AGAWEED PROJECT

Mechanical Car Parking System Lay-out Plan
Grand Parking 300 Cars
DATE : 02. 09. 2020



ATECO CORPORATION

اتيكو كورپوريشن